

Smart Sepoh

THE DUAL-PURPOSE SURFACE FINISH

www.anutone.com/sepoh.htm

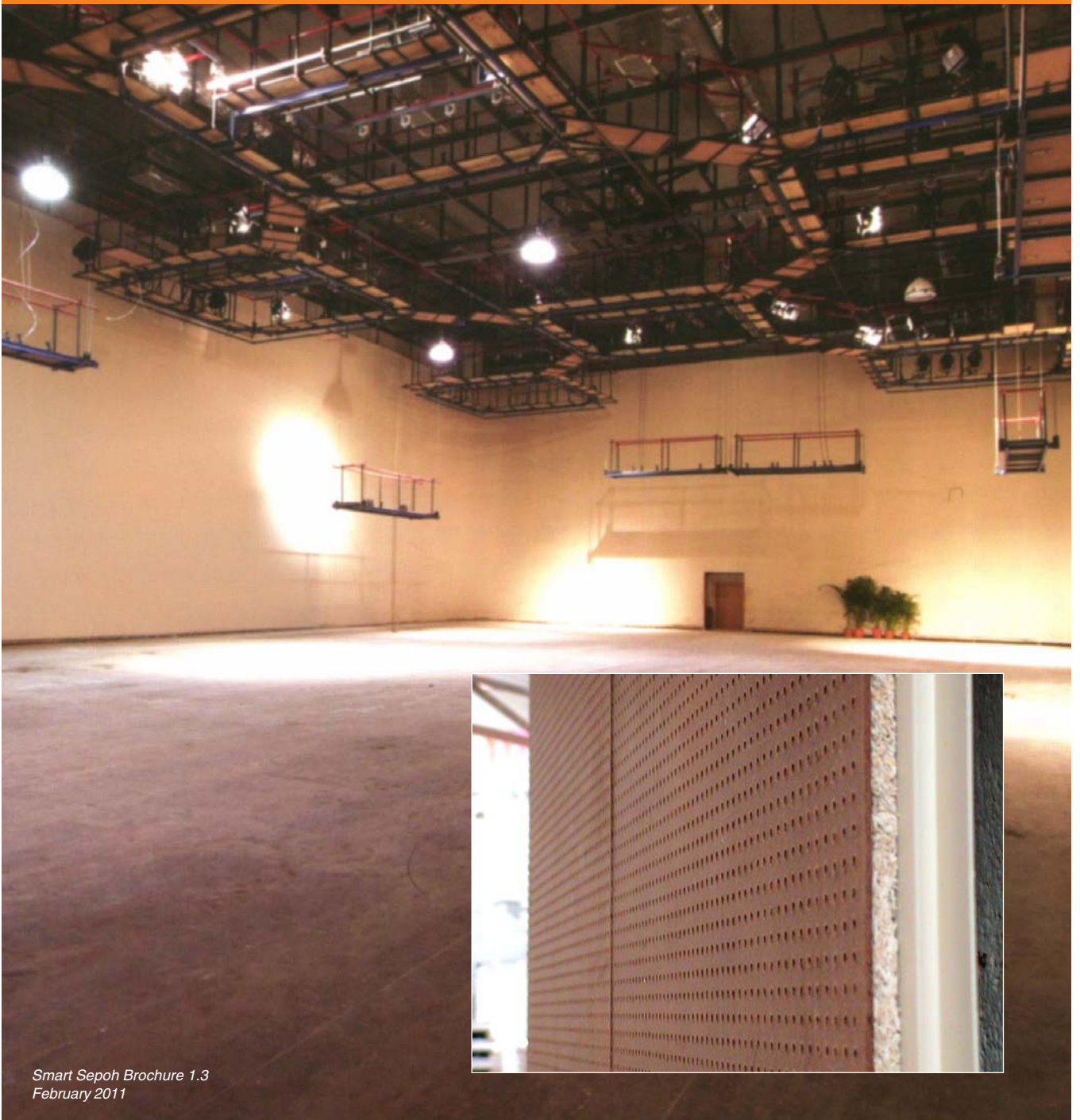

Key Attributes

An Anutone invented surface finish, Smart Sepoh absorbs, blocks *and* covers surfaces of many commonly used spaces! Virtually, the ABC of contemporary office and entertainment acoustics, Smart Sepoh solution is a dual-purpose acoustic panel that combines new-age aesthetics and functional acoustics.

Typical Applications

Smart Sepoh improvises exposed surfaces such as wall panellings where both sound absorption is a necessity. The application spaces include studios, cinema multiplexes, home theatres, AV rooms, discotheques, lounge bars etc.

Visual Variants

The visual variants to Smart Sepoh are realised when the panels are insitu spray painted in a range of bold, contrast or pastel colours.

Other surface options include Burl and Fabrico finishes. it is also optionally precoated in 10 colour choices of which three choices are in simulated wood.



Features

The feature-rich Smart Sepoh is unique for its

- Surface finish- perforated hardboard
- Perforation 5mm diameter at 15mm pitch for 12 per cent open area, regular perforation pattern
- Surface board - 1000kg/m³ x 4mm thick
- Oil-tempered,
- FR grade
- Base panel - two densities ND4, VDH™
- Binder - MB
- Dimensions - widths of 600mm and lengths of 1200mm
- Thickness* - 15mm (for ceilings only), 20mm, 25mm, 30mm
- Edge profile - Normal, H-Spline groove.

*Caution! Add 4mm to base panel for overall thickness



Aesthetics

Smart Sepoh boasts of an exposed surface, since edge treatment is important for installed aesthetics. For ceilings, Smart Sepoh has edge profiles in Square.

For panellings, edge profiles consist of Square with H-Spline groove in which AnutoneSplines E/H/I can be fixed. The perimeter can be camouflaged with AnutoneSpline J.

Design Considerations

Smart Sepoh Square edge must never be butt- jointed without using the AnutoneSplines option.

Smart Sepoh must not be installed at pedestrian height unless the surface is covered with a finishing materials such as AnutoneSpun fabric / vinyls system.

Tech Performance

Base panel

- Non-combustibility – Mass loss 53 per cent @ 750 °C - ISO 1182
- Ignitibility – 'P' - BS 476 Part 5
- Fire Propagation Index – 5.17 - BS 476 Part 6
- Surface Spread – Class I - BS 476 Part 7
- Specific Optical Density of Smoke – Flaming Exposure 26.28 D_m (Corr) - ASTM E662
- Thermal Conductivity – 0.08 Wm/k - IS 3346

Environmental Friendly

Smart Sepoh is an eco-friendly system and wins GBC's 15 LEED points when used in green buildings.

Technical Primer

SI#	Description	Smart Sepoh	Smart VDH Sepoh
1	Thickness* (mm)	15 / 20 / 25 / 30	25
2	Size (mm)	Width 600 & Length 1200	Width 600 & Length 1200
3	Core	Unique Fiber construction	
4	Nominal Density (Kg / m3)	400	
5	Weight (Kg / m2)	8 to 12	
6	Edge	Square edge, H-Spline Groove	
7	NRC / STC	Upto 0.9	
8	Fire	Class A	
9	Moisture Resistance (%)	RH 70	
10	Light Reflectance (%)	Colour Dependent	
11	Warranty	10 years	
12	Installation	JEHI-Splines	
13	Colours (pre-coated)	Dark Grey, Ivory, Pista, Dark Red, White, Wood Teak, Wood Rose, Light Blue, Dark Ivory	
14	Maintenance	Vaccum / Wetwipe	

* Add 4mm to base thickness

Bill of Quantities (BoQ) - 100m²

SI#	Description	Units	Qtys
1	Strut CC22	1m	198
2	Splines	1m	288
3	Stick S7	Ltrs	35
4	Synth PF 10x25mm thick	m ²	100
5	Smart Sepoh 1200x600x20mm thick	m ²	100
6	Labour	hour	3
	Estimated installed Cost / m²	₹	

* The above indicated values are very approximate and dependent on several variables. They are for guidance only and subject to change without prior notice.

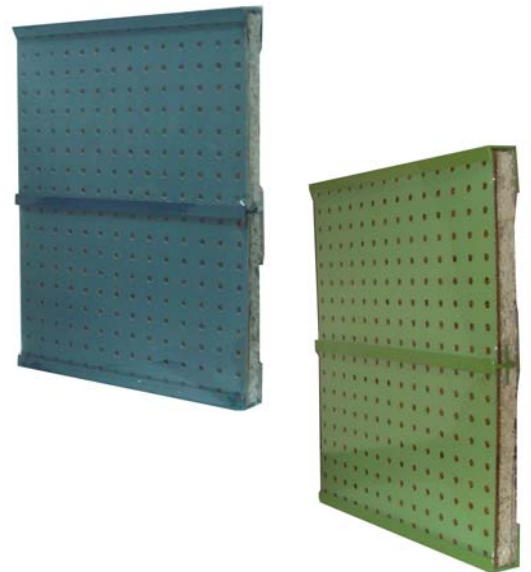

Installation Guidelines

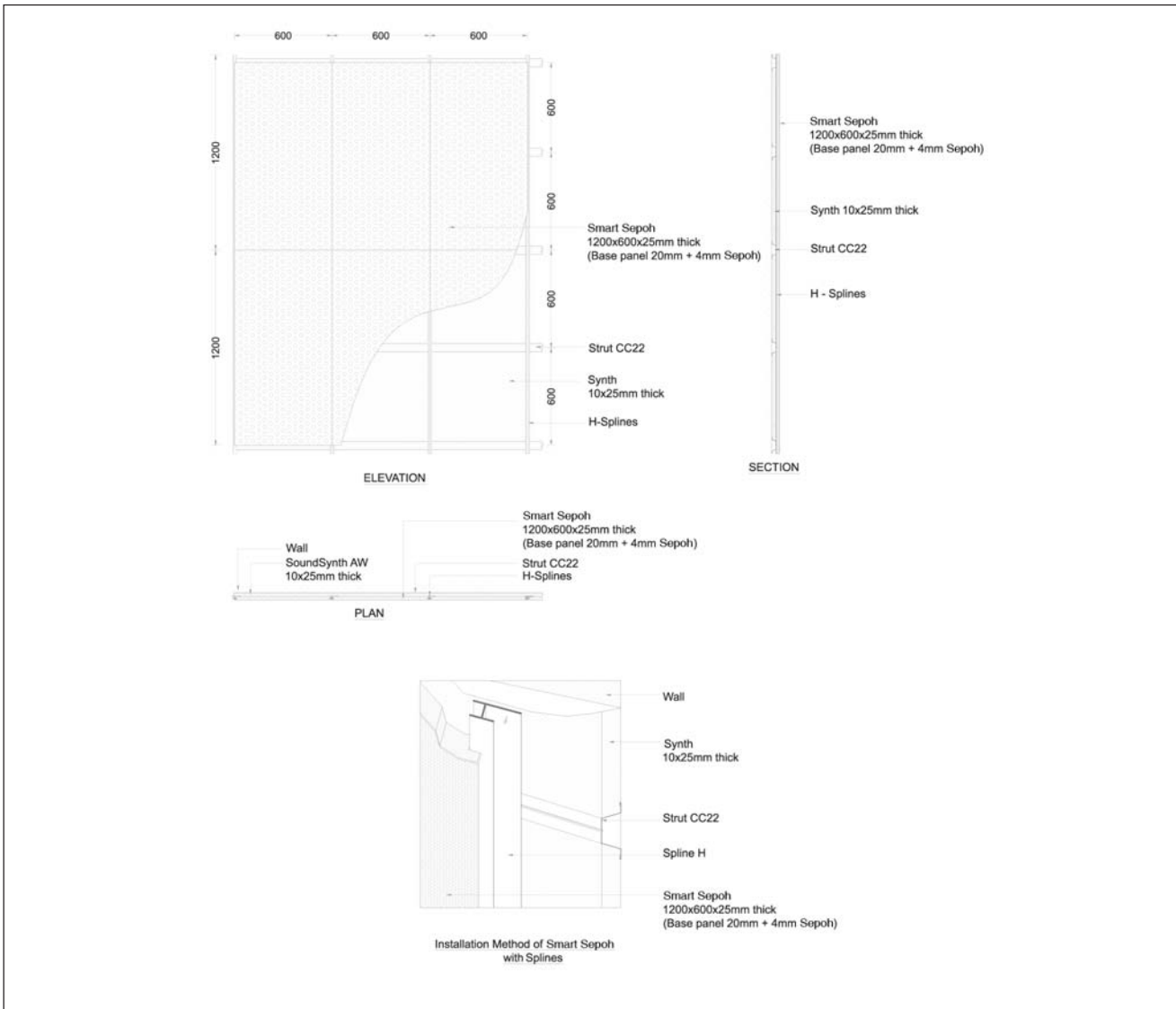

ANUTONE WALLS & CEILINGS

a division of Anutone Acoustics Limited

231, 7th Cross, Indiranagar 1st Stage, Bengaluru 560 038, India
 Phone +9180 2520 3114 Fax +9180 2520 3115 info@anutone.com

MUMBAI

+9122 2643 9732

DELHI

+9111 2437 8061

CHENNAI

+9144 4305 4935

www.anutone.com



Anutone is member of

