

in association with
Owens Corning USA



anutone[®]
makes you feel good[™]

Stretch KLH

VINYL WALL COVERINGS
www.anutone.com/klh.htm





Stretch Your Imagination

Have you ever imagined microperf vinyl covering transform an otherwise coarse and rough interior wall surface transmit soft lighting, sound good and pose amazing looks? Have you ever wondered the vinyl covering transforming the otherwise flat walls into a harmonic surface that accentuates the interiors into an entirely new, inviting ambience? Have you ever tried exploring the unbounded horizon of microperf vinyl-treated interiors to unveil unbelievably wonderful ambiances? Come! Stretch your imagination! Explore the universe of vinyl-induced creative choices, that are widespan, in the truest sense of the word, and can look like luxuriant leather, to make the living world incredibly enlivening with form and function!

Introducing the Stretch KLH system, brought to you by Anutone India, in association with Owens Corning USA, unfolding the fascinating world of vinyls - to excite the imaginative capabilities of designers, to meet the techno-economic requirements of consultants, to ease the arduous risks of installers, and, to bring the collective benefits to the space owners / users. Interior space design can never be the same again.

Key Attributes

Stretch KLH is a complete system that can redefine practically any interior ambience by virtue of its visually aesthetic and functionally acoustic credentials. It essentially consists of four elements:

- High-performance integrated core
- A unique tensioning track arranged around the perimeter
- Micro-perforated vinyl, stretched and held by the track
- System installation by certified system professionals.

The result is an outstanding wall surface with outstanding acoustical properties.

Stretch KLH System merges unobtrusively with the interior design just as it blends perfectly with the architect's imagination and the building owner's needs.

Any Surface, Any Space

Stretch KLH enables architects weave any speciality design into any space, exploring their creative abilities. Walls can be covered in a wide range of striking vinyl colours to give a clean, colourful acoustically transparent finish. Large walls in any commercial or institutional environment can be beautifully and functionally designed.

Large Format

With Stretch KLH system, spaces of maximum 1.2 x 20m (24m2!) can be covered seamlessly in a single span. Larger areas can be spanned almost invisibly. Moreover, reveals can be specified to highlight the edges.

Stretched Interior Systems

The Stretch KLH system is constructed at site to accommodate various field conditions allowing a wide variety of vinyls to be stretched over acoustical substrates. The flexibility lets the installer work precisely around acute and obtuse angles, out of plumb conditions, and bulging walls. The vinyl is securely tucked and tensioned into the locking jaws of a concealed track at the perimeter and joints.

Complete Versatility

The Stretch KLH uses a special micro perforated technique that ensures vinyl integrity over the entire stretched surface. The colour choices are mind-boggling from pastels to contrasts to bolds to darks! Choices include track depths of 25 and 12mm. 4 track types - perimeter half-wrap; perimeter full-wrap; midseam and outer corner. Track edges profiles include Square, Radius, Bevel.

Fascinating Form n Function

The Stretch KLH system is a fascinating combination of form and function. Complementing the visually beautiful speciality vinyl is the accompaniment of 10 mm acoustical substrates that come with an NRC rating upto 1.00. The vinyl is micro-perforated and hence acoustically transparent, a characteristic that allows loudspeakers to be cleverly hidden from view without inhibiting sound clarity, very similar to cinema screen loudspeakers.

Easy Maintenance

The Stretch KLH system is one of the most easy systems to maintain a beautiful wall. The vinyl can simply be vacuumed or wet-wiped, and regular cleaning agents can be employed for spot removal. If needed, the vinyl can even be removed, cleaned and reinstalled.

Unprecedented Warranty

One of the most arresting features of the Stretch KLH system is an unprecedented 5 year warranty. It is guaranteed not to wrinkle or sag due to heat, humidity or aging for a full 5-year period.

Proven Technology from Proven Leaders

That the Stretch KLH system is brought to the industry by two of the most trusted technology leaders makes it all the more reliable. While Anutone Acoustics Limited has emerged to be the most dynamic design-supply-build solutions leader, Owens Corning has an acclaimed history of over 25 years for highly functional and elegant speciality interior solutions.

The domain expertise gained over the years enables Anutone to offer complete installation by certified professionals. Extensive experience complimented by special training helps complete the install with minimal mess but optimal efficacy.

Visual Variants



GENERAL

1.01 Scope

- A. Supply and install Stretch KLH Wall System as initiated by Anutone Acoustics Limited Bangalore-India and Owens Corning USA and as required by the Contract Document.
- B. Related Work Elsewhere
 - 1. Preparation of smooth, flat and plumb substrate.
 - 2. Architectural Woodwork, Masonry, Doors and Frames, Hardware, Gypsum Drywall, Plastering, Ceilings, Wall Covering Painting and Electrical Work.

1.02 Standards

- A. The Stretch KLH Wall System vinyl shall have a fire hazard classification of Class A / Class I per ASTM E84 with flame spread of 0 and smoke density of 5.
- B. Stretch KLH System – Assembly Test –Class A/Class I per ASTM E84 with a flame spread of 5 and smoke density of 35 installed on gypsum board.

1.03 Qualifications

The installation work of this section shall be performed by an authorized applicator, licensed by the manufacturer.

1.04 Quality Assurance

- A. The KLH is aligned to the Stretch Tracks by following the vinyl thread line or pattern. The KLH is stretched and tucked into the Stretch Tracks.
- B. The vinyl border shall be inserted completely into the clamping jaws of the Stretch Track framework creating a clean crisp appearance devoid of raw edges or loose threads
- C. The vinyl shall be installed from the face side after the framework is securely fastened to insure perfect horizontal and vertical grain alignment
- D. The vinyl shall be removable and replaceable for changeability and to provide access to the surface behind the vinyl
- F. The framework shall not *read through* the vinyl
- G. Acoustical core shall be installed beneath the face vinyl in the event a translucent vinyl has been specified
- H. Noise Reduction Coefficient of 0.80 as per ASTM C423 A mounting or 1.00 in E-400 mounting (25 thick acoustic infill) or as specified shall be ensured

1.05 Submittal

- A. Product Data
Submit manufacturer's product specifications including certified laboratory test reports and other data required to show compliance with these specifications

- B. Samples
Provide A4 size (210x280mm) samples of vinyl, and representative samples of rigid plastic mounting devices
- C. Certified Test Reports
Submit test data from an independent testing agency, acceptable to authorities having jurisdiction, evidencing that systems components comply with requirements indicated for fire performance characteristics. Submit test data from independent testing agencies showing that system complies with the specified requirements for acoustical performance
- D. Submit installation dealer's Limited Warranty against defects in the Stretch Track materials and workmanship

1.06 Product Handling

- A. Store all materials off the ground and protected from dirt and dust of construction operations
- B. Handle materials in a manner that will protect them from damage and soiling

1.07 Product Drawings

- A. Drawings showing typical plan, sectional views and details are to be submitted to the architect/designer

1.08 MAINTENANCE

- A. Extra Stock: Matching replacement stock of Stretch KLH, as requested by the owner, shall be maintained as extra stock to meet exigencies.

PRODUCTS

2.01 Wall Treatment System

- A. The system shall consist of site installed and perforated, concealed Stretch KLH system as manufactured by Anutone Acoustics Limited
The System Components shall consist of the following
 - 1. Rigid vinyl framework with clamping jaws, with SB10 (used only for masonry walls) as indicated in drawings (Select correct thickness below, eliminate others not used)
Stretch KLH System is available with the following profiles. (Select the correct profile below) – Height of tracks is 12 and 25 mm
 - a. Perimeter Track half wrap
 - b. Perimeter Track full wrap
 - c. Mid Seam Track
 - d. Outer corner Track

Stretch KLH System is available with the following sub-surfaces (underlay).

- a. 10mm Strand with 10mm Synth PF
- b. 10mm Synth PF

Vinyl

1. Stretch KLH vinyl, in a standard or custom colour, as supplied by Anutone Acoustics Limited
2. Fire Hazard Classification: Independently tested as Class A per NFPA or Class I per UBC with a flame spread index of 0 and smoke developed of 5 as per ASTM E84 test procedure.

Vinyl shall be a stretch type that is capable of elongating 15 percent and have the ability to stretch in a horizontal plane with maximum deflection less than 10mm in a 1.2m span.

3. Vinyl shall be available in a maximum width of 1.2m. The vinyl shall be spot-cleanable and dry-cleanable.
4. Acoustical Core: Standard system consists of 10x10mm thick Synth AW. Other cores with various thickness and densities are available to meet specific acoustical requirements.
6. Stretch KLH Ceiling System vinyl mounting devices are nominal 12 and 25 mm rigid FR-PVC high strength extrusions produced in perimeter and midseam tracks.
7. Perimeter track is available in square edge. Exposed edges selectively covered with matching vinyl colour
8. Midseam Track available:
 - a) Square
 - b) Flexible - for achieving curved lines, or conforming to concave or convex surfaces
 - c) Capability to install vertical and/or horizontal panels continuously without joints
 - d) When track profile to be fixed on masonry wall, SB10 is used prior to mounting the track
 - e) If the edges of this SoundBase is exposed they shall be finished with the Stretch KLH or painted as specified.
9. Anchoring System: Stapler that has mechanical ability to diverge staples for attaching extrusions, 18 gauge wire size. Other fastening systems, approved by manufacturer may be used.

A. Install materials in accordance with manufacturer's instructions, and comply with governing regulations, fire resistance rating requirements, as indicated, and industry standards applicable to the work.

B. Apply the Stretch track mounting system to surfaces that are to receive the treatment. Secure with pneumatic stapler using 25mm staples spaced on 50mm centres.

Other fasteners may be used as may be required for specific substrates, provided they are in strict accordance with the manufacturer's instructions and comply with the governing regulations and fire-resistance rating requirements specified.

C. Install Tracks system level and straight, flush and in proper alignment.

D. Install the acoustical core material, continuous and flush to the edge of the track in largest sizes practical and secure in place with a suitable adhesive or staples. If the vinyl is to be closer than 6mm to the core then the joints shall be caulked and/or a white scrim or lining shall be used to prevent *read through*. The scrim or lining shall not inhibit the acoustical performance of the system and meet all the necessary fire safety code requirements.

E. Shop cut the Stretch KLH vinyl slightly oversized for each area to be covered. Label each piece and package in clean containers for transportation to job site. Larger projects may require full rolls to be shipped to the job site where a clean cutting and staging area must be maintained.

F. Stretch the vinyl and secure into the locking jaws so that it will be smooth, free of wrinkles or puckers. Trim off excess vinyl at perimeter and tuck remaining material into storage channel of the extrusion.

G. Examine vinyl as it is installed for damage, imperfections, and soiling. Notify other trades to use care in working around the installed Stretch KLH vinyl so as not to soil or damage the surface.

EXECUTION

3.01 EXAMINATION

- A. Examine the condition of the substrate and the conditions under which the work of this section is to be performed. Notify the contractor in writing of any unsatisfactory conditions. Do not proceed with the work until unsatisfactory conditions have been corrected in a manner satisfactory to the installer.
- B. Field measure each ceiling area which is to receive the AnutoneStretch KLH system to establish the correct layout.

3.02 INSTALLATION

General

3.03 CLEANING AND PROTECTION

- A. Clean exposed surfaces as necessary. Comply with manufacturer's instructions for cleaning and repair of minor finish damage. Remove and replace work that cannot be successfully cleaned and repaired to permanently eliminate evidence of damage.
- B. The Installer shall advise the contractor on required protection, including soiling from other trades and dust control, so that the work will be without damage and deterioration at the time of acceptance by the owner.

Installation Drawings

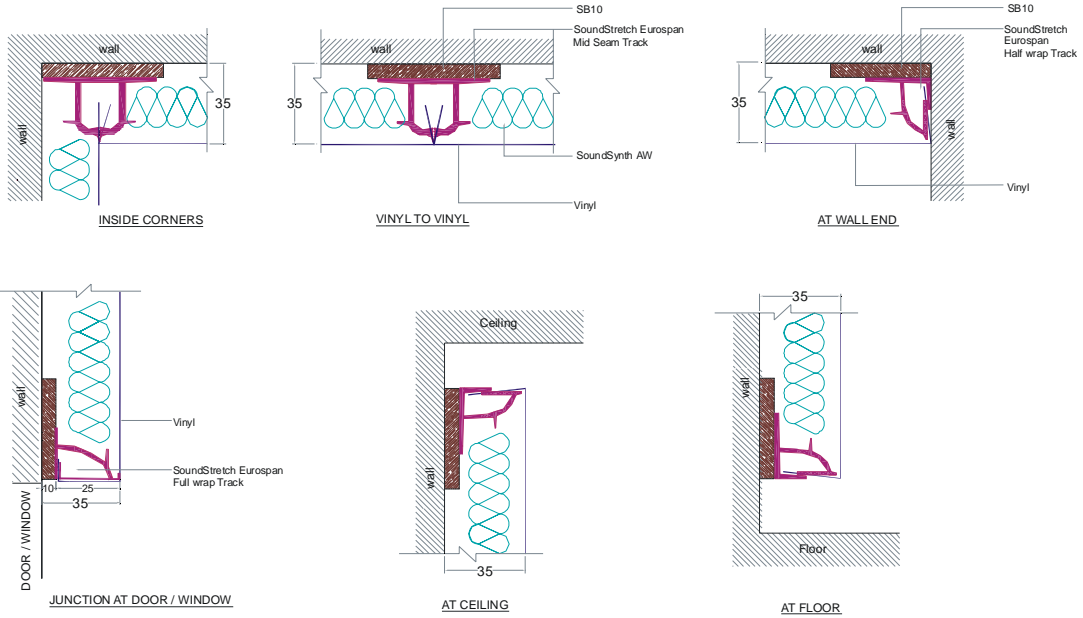

ACCESSORIES		
①	SB 10	
②	SoundStitch Metal Fasteners (M10x25)	
③	SoundStretch Eurospan Perimeter half - wrap Tracks	
	SoundStretch Eurospan Perimeter full - wrap Tracks	
	SoundStretch Eurospan Mid - Seam Tracks	
	SoundStretch Eurospan Outer Corner Tracks	
	SoundStitch Staple	
⑤	Acoustic Core Panel	
⑥	SoundSynth AW	
⑦	SoundStretch Eurospan KLH	
⑧	SoundStick S7	

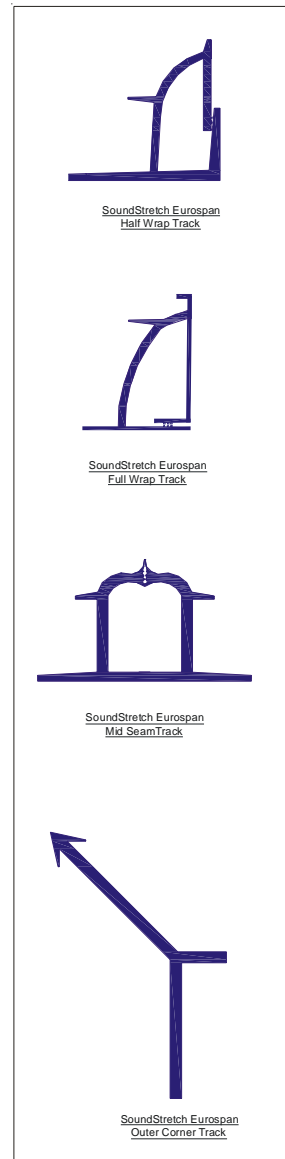
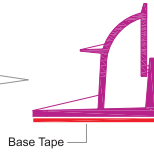

Tender Specifications

Supply and Installation of Stretch KLH system, consisting of AnutoneBase (AB) of 10mm thick, rigid vinyl Stretch Tracks, core material and textile.

AnutoneBase AB10 is first installed on the masonry wall/CC25 by using Stitch fasteners at every 300mm centres in a staggered pattern. AB10 shall be fixed at designed centres. Stretch Tracks are then installed on AB10 by using Stich heavy-duty diverging staples at every 25mm centres on both sides of Stretch Tracks.

Install core first between AB10 by using Stitch fasteners and Synth PF is then friction fitted with light spots of Stick S7. The adhesive spots can be 50mm dia dabs at 300mm centres.

KLH vinyl is then aligned to the Stretch tracks by following the fabric thread line or pattern. The KLH vinyl is stuck on the alignment tape (by removing the protective cover) and the same being stretched and tucked into the Stretch tracks.

Technical Specifications

Sl#	Description	Stretch KLH
1	Thickness (mm)	25 / 12
2	Size (mm)	(single span upto 1370 x 25000)
3	Core	Strand / Synth PF
4	Nominal Density (Kg/m ³)	NA
5	Weight (Kg/m ²)	NA
6	Edge	Square
7	NRC / STC	Upto 1.0
8	Fire	Class I
9	Moisture Resistance (%)	RH 90
10	Light Reflectance (%)	80
11	Warranty	5 years
12	Installation	Vinyl Tracks
13	Colour	Vinyl shades
14	Maintenance	Vacuum

Only KLH Vinyl

Thickness	0.26 inches
Weight	21 ounces per linear yard

Bill of Quantities (BoQ) - 100m²

SI #	Description	Units	Stretch Eurospan KLH			
			Wall Vinyl Tracks A-Mounting		Wall Vinyl Tracks C-Mounting	
	Thickness / Edge	mm	25mm	12mm	25mm	12mm
1	SB10*	lm	178	178	—	—
2	Strut CC50	lm	—	—	198	198
3	Stretch Perimeter Track Half Wrap	lm	48	—	48	—
4	Stretch Perimeter Track Full Wrap	lm	48	48	48	48
5	Stretch Track Mid Seam	lm	76.8	76.8	76.8	76.8
6	Stretch Track Outer Corner	lm	4.8	4.8	4.8	4.8
7	Smooth 400x30	m ²	100	100	100	100
8	Synth PF	m ²	100	100	100	100
9	Stretch KLH	m ²	100	100	100	100
10	Stick S7	Lts	35	35	35	35
11	Stitch Metal Fasteners (M10x25)*	Nos	LS	LS	LS	LS
12	Stitch Staple	Nos	LS	LS	LS	LS
13	Labour	hrs	4	4	4	4

lm - Linear meter, m² - Square meter, Ltr - Litre, LS - LumpSum, hrs - Hours

* The above indicated values are very approximate and dependent on several variables. They are for guidance only and subject to change without prior notice.



anutone®
makes you feel good™

ANUTONE WALLS & CEILINGS

a division of Anutone Acoustics Limited

231, 7th Cross, Indiranagar 1st Stage, Bengaluru 560 038, India
Phone +9180 2520 3114 Fax +9180 2520 3115 info@anutone.com

MUMBAI

+9122 2604 2917

DELHI

+9111 2437 8061

CHENNAI

+9144 2833 0906

www.anutone.com



Anutone is member of

