

TECH PRIMER 2007

Release 1.0 – April 2007



SoundStretch™ Eurospan™



INNOVATIONS FOR LIVING™

Absol™
CONTRACT ACOUSTICAL SYSTEMS

SoundStretch™ Eurospan™



A legacy of acoustic innovation

The coming together of Anutone® and Owens Corning® with the SoundStretch™ Eurospan™ range of acoustical systems and services benefits customers in the SAARC and GCC regions of Asia with a heritage of excellence that spans more than 25 years.

Both are recognised leaders in the design and manufacture of acoustical interior wall and ceiling products and office systems that meet the ever-changing needs of companies, architects, builders, and space planners in almost every commercial, industrial and institutional industry.

The guidelines in this Tech Primer are given in good faith to help avoid common errors. They are not intended to be a step-by-step list of instructions or a checklist, and it is assumed the installer has general interior construction knowledge. Absol™ bears no responsibility for any installation actions taken or not taken, and is not responsible for installer selection.

Inspection

- **Transit Damage:** Inspect cartons for obvious damage before accepting and note on delivery challan.
- **Concealed Damage:** Notify Absol™ of any concealed damage within 3 working days of receipt. Claims beyond 3 days will be honoured at the discretion of Absol™ or the transport company.
- **Do not install panels of unacceptable quality.** Contact SoundSquad™ at SoundSupport™ centres immediately. Absol™ will not be responsible for installation or removal costs of unacceptable components.

Handling and Storage

- *Handle* individual components carefully to avoid bending, creasing, soiling when moving and carrying.
- *Store* components on a flat, dry, solid surface. Do not store on edge.
- Take necessary measures to keep components dry, clean and free from dust.

SoundStretch™ Eurospan™ Specifications

PART 1- GENERAL

1.01 SUMMARY

A. Section Includes

A field installed SoundStretch™ Eurospan™ Ceiling System consisting of a laterally suspended textile, applied over an acoustical core, attached to a continuous mounting system of nominal 38mm rigid plastic extrusions as shown on the drawings and supplied by Anutone Acoustics Limited.

1.02 SUBMITTALS

A. Product Data

Submit manufacturer's product specifications including certified laboratory test reports and other data required to show compliance with these specifications.

B. Samples

Provide 300 x 300mm samples of fabric, and representative samples of rigid plastic mounting devices.

C. Certified Test Reports

Submit test data from an independent testing agency, acceptable to authorities having jurisdiction, evidencing that systems components comply with requirements indicated for fire performance characteristics. Submit test data from independent testing agencies showing that system complies with the specified requirements for acoustical performance.

1.03 QUALITY ASSURANCE:

- A. Fire Hazard Classification: SoundStretch™ Eurospan™ Textile - Class A / Class I per ASTM E84 with flame spread of 0 and smoke density of 5. SoundStretch Eurospan System – Assembly Test –Class A /Class I per ASTM -E84 with a flame spread of 5 and smoke density of 35 installed on gypsum board
- B. Noise Reduction Coefficient of 0.80 as per ASTM C423 A mounting or 1.00 in E-400 mounting (25 thick acoustic infill) or as specified.
- C. Installer Qualifications
The installation work of this Section shall be performed by an experienced installation contractor approved by the manufacturer, and certified as such.

1.04 DELIVERY, STORAGE AND HANDLING

- A. Protect system components from excessive moisture in shipment, storage, and handling. Deliver in unopened bundles and store in a dry place with adequate air circulation. Do not deliver material to building until "wet conditions" such as concrete, plaster, paint, and adhesives have been completed and cured to a condition of equilibrium.

1.05 PROJECT CONDITIONS:

- A. Do not install SoundStretch™ Eurospan™ Ceiling System until space has been enclosed and is weathertight, and until other finishes and wet-work in the space have been completed and are nominally dry.

1.06 MAINTENANCE:

- A. Extra Stock: As an option, matching replacement stock of SoundStretch™ Eurospan™ fabric of amounts requested by Owner may be required.

1.07 PRODUCT DRAWINGS:

- A. Drawings showing typical reflected ceiling plan, sectional views and details are to be submitted to the Architect/Designer.

PART 2 – PRODUCTS

2.01 SYSTEM:

- A. Provide a complete system, known as SoundStretch™ Eurospan™ Ceiling System, including anchoring, as supplied by Anutone Acoustics Limited consisting of SoundStretch™ Eurospan™ textile field applied over acoustical core and mounted securely to perimeter, mid joint, and corner extrusions that tension the fabric tightly but permit removal of fabric, as required for replacement.
- B. Include required accessories as detailed or specified.

2.02 MATERIALS

A. Fabric:

1. SoundStretch™ Eurospan™ Ceiling Textile, in a standard white or custom colour, as supplied by Anutone Acoustics Limited.
2. Fire Hazard Classification: Independently tested as Class A per NFPA or Class I per UBC with a flame

spread index of 0 and smoke developed of 5 per ASTM E84 test procedure. Test mounting method: Loose laid on 50mm hexagonal wire mesh with metal rods at 600mm centres. Test method with fabric adhered to cement board not acceptable.

Note: Complete assembly test (extruded track, SoundStretch™ Eurospan™ textile, 25mm acoustical core). Flame Spread 5, Smoke Developed 35. Fabric shall be a stretch type that is capable of elongating 25 percent and have the ability to stretch in a horizontal plane with maximum deflection less than one inch in a 5m span. 4. Fabric shall be available in a maximum width of 5m. The fabric shall spot cleanable and dry cleanable. 5. The standard colour of the fabric is white with minimum light reflectance of 0.75. 6. The fabric shall be of a fibre content and locking weave so as not to be affected by heat or humidity for the life of the installation.

B. Acoustical Core: Standard system consists of 10x25mm thick SoundSynth™ AW. Other cores with various thickness and densities are available to meet specific acoustical requirements.

C. SoundStretch™ Eurospan™ Ceiling System fabric mounting devices are nominal 38mm rigid FR-PVC high strength extrusions produced in perimeter and mid joint profiles.

1. Perimeter track is available in square or bevel. Exposed edges selectively covered with matching fabric or painted to match the fabric. 2. Mid Joint Track available: a) Square b) Reveal type c) Flexible for achieving curved lines, or conforming to concave or convex surfaces. d) Capability to install vertical and/or horizontal panels continuously without joints. e) When core material is thicker than track profile, FR-ply tracks are used prior to mounting the track. f) If the edges of these ply tracks are exposed they shall be finished with the SoundStretch Eurospan fabric or painted as specified. 3. Anchoring System: Stapler that has mechanical ability to diverge staples for attaching extrusions, 18 gauge wire size. Other fastening systems, approved by manufacturer may be used.

PART 3 – EXECUTION

3.01 EXAMINATION:

A. Examine the condition of the substrate and the conditions under which the work of this Section is to be performed. Notify the Contractor in writing of any

unsatisfactory conditions. Do not proceed with the work until unsatisfactory conditions have been corrected in a manner satisfactory to the installer.

B. Field measure each ceiling area which is to receive the SoundStretch™ Eurospan™ Ceiling System to establish the correct layout.

3.02 INSTALLATION:

General:

A. Install materials in accordance with manufacturer's instructions, and comply with governing regulations, fire resistance rating requirements, as indicated, and industry standards applicable to the work.

B. Apply the rigid plastic mounting system to surfaces that are to receive the treatment. Secure with pneumatic stapler using 25mm staples spaced on 50mm centres.

Other fasteners may be used as may be required for specific substrates, providing they are in strict accordance with the manufacturer's instructions and comply with governing regulations and fire resistance rating requirements specified.

C. Install rigid plastic mounting system level and straight, flush and in proper alignment.

D. Install the acoustical core material, continuous and flush to the edge of the track in largest sizes practical and secure in place with a suitable adhesive or staples. If the fabric is to be closer than 6mm to the core then the joints shall be caulked and/or a white scrim or lining shall be used to prevent "read through." The scrim or lining shall not inhibit the acoustical performance of the system and meet all the necessary fire safety code requirements.

E. Shop cut the SoundStretch™ Eurospan™ fabric slightly oversized for each area to be covered. Label each piece and package in clean containers for transportation to job site. Larger projects may require full rolls to be shipped to the job site where a clean cutting and staging area must be maintained.

F. Stretch the fabric and secure into the locking jaws so that it will be smooth, free of wrinkles or puckers. Trim off excess fabric at perimeter and tuck remaining material into storage channel of the extrusion.

G. Examine fabric as it is installed for damage, imperfections, and soiling. Notify other trades to use care in working around the installed SoundStretch™ Eurospan™ fabric so as not to soil or damage the surface.

3.03 CLEANING AND PROTECTION

- A. Clean exposed surfaces of ceiling surface as necessary, comply with manufacturer's instructions for cleaning and repair of minor finish damage. Remove and replace work that cannot be successfully cleaned and repaired to permanently eliminate evidence of damage.
- B. The Installer shall advise the Contractor of required protection, including soiling from other trades and dust control, so that the work will be without damage and deterioration at the time of acceptance by the Owner.

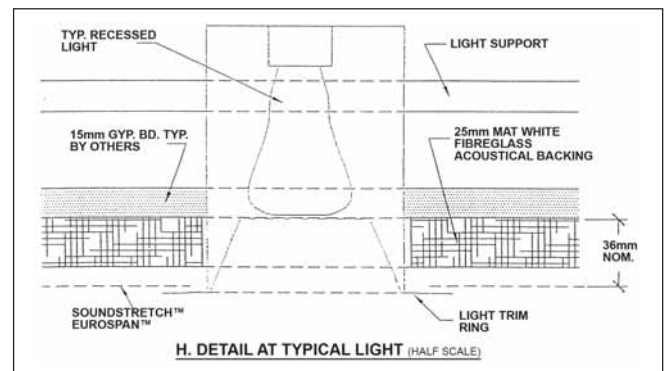
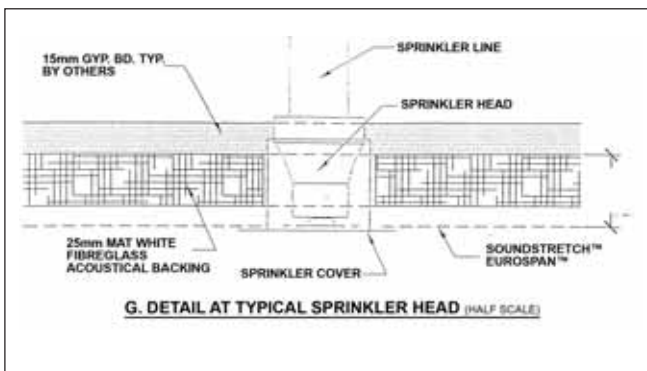
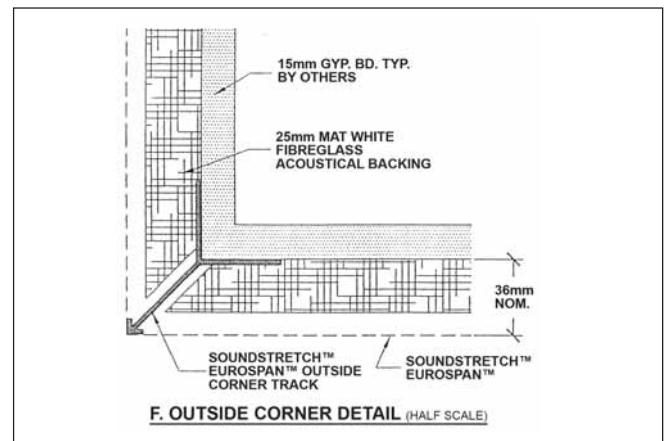
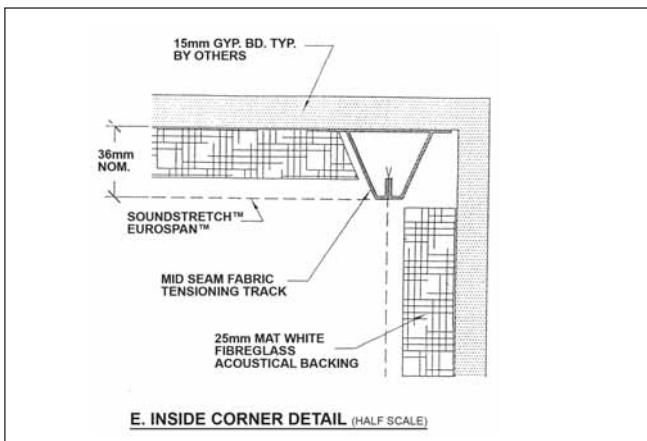
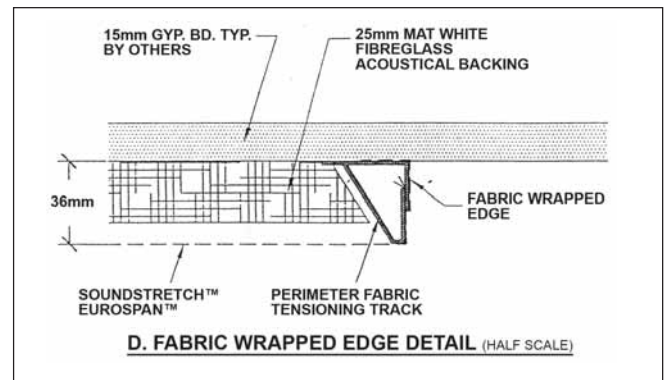
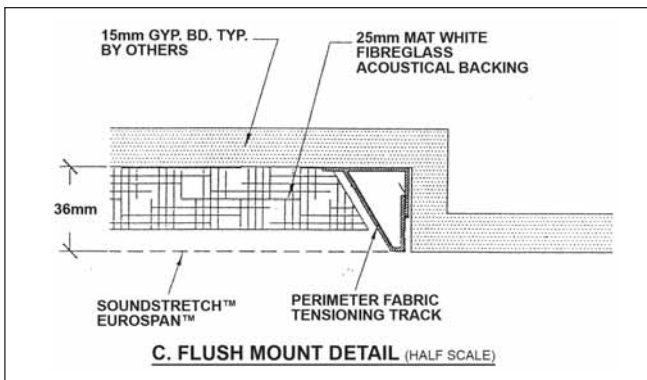
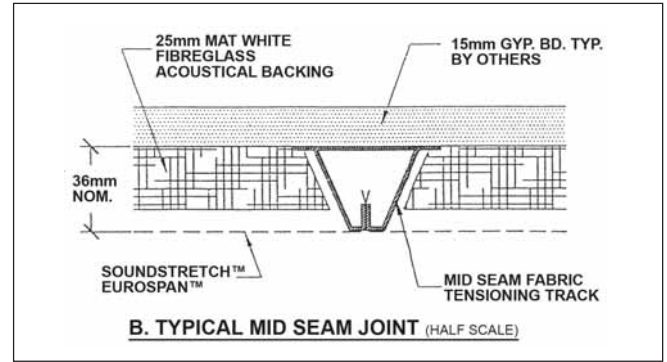
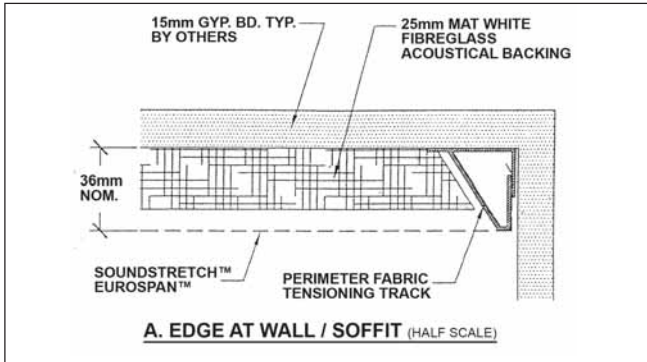

WARRANTY AFTER COMPLETION

Absol™ hereby agrees to remedy any defects due to faulty materials or workmanship appearing in acoustical wall or ceiling products supplied by Absol within a period of *one year* from the date of final acceptance of work. Our liability is expressly *limited* to replacement of defective goods.

In addition to the above, the SoundStretch™ Eurospan™ Ceiling System is warranted not to sag or wrinkle due to heat, humidity or aging for a period of ten years after final

acceptance of work. Defects resulting from faulty overhead construction, plumbing, ventilation systems, or impact to the face of the SoundStretch™ Eurospan™ is not covered under this warranty. Absol will replace any SoundStretch™ Eurospan™ fabric, *including installation*, where such sagging or wrinkling occurs. This is the sole remedy under this warranty and Absol™ *disclaims all implied warranties, including incidental or consequential damages.*

MAINTENANCE AND CLEANING GUIDE

- 1. Preventive Measures:** Wear clean protective gloves or have clean hands when working around or with SoundStretch™ Eurospan™ fabric. Installation or removal of fabric for access should be performed by trained and qualified personnel.
- 2. General Maintenance:** Periodic brushing or light vacuuming of the SoundStretch™ Eurospan™ fabric is recommended for removal of loose dust and airborne particles. Blowing off with clean compressed air also works well and reduces the chance of pushing particles into the fabric.

- 3. Stain Removal:** The fiber used in the SoundStretch™ Eurospan™ fabric allows the use of both water-based and solvent-based cleaning agents. A product called KR2 Spot Lifter works well. A special “Dry Cleaning Sponge” works well on most light stains. These sponges are shipped with each SoundStretch™ Eurospan™ order. For large and unusual stains, or for overall cleaning, contact a reputable professional cleaning service.

PARTIAL LISTING OF RECENT INSTALLATIONS

- Adobe Software (San Jose, CA)
Lobby
- Ala Moana Mall (Honolulu, HI)
Makai Market Food Court
- All Saints Church (Palo Alto, CA)
Sanctuary Ceiling and Walls
- Altera Software (San Jose, CA)
Boardroom Lobby
- Anderson Consulting (Houston, TX)
Conference Room
- Architect’s Office (Salt Lake City, UT)
Open Office Ceilings
- AT & T (Denver, CO)
Network Control Center
- Bank of Broomfield (Broomfield, CO)
Lobby Barrel Vault Ceiling
- Bank of Longmont (Longmont, CO)
Lobby Barrel Vault Ceiling
- Bank of Louisville (Louisville, CO)
Lobby Barrel Vault Ceiling
- Bayou Club (Houston, TX)
Banquet Room
- Beau Rivage (New Orleans, LA)
Showroom
- Beau Rivage (New Orleans, LA)
Brew Pub
- Bentley Health Care (New York, NY)
Reception Area, Conference Room
- Blue Shield of California (Lodi, CA)
Cafeteria Areas
- Boise Art Center (Boise, ID)
Main Gallery
- Boulder Ridge Country Club (Lake Forest, IL)
Banquet Rooms
- Brigham Young University (Provo, UT)
Wilkinson – Commons
- Burlingame Public Library (Burlingame, CA)
Upper Wall, Reading Room
- Caesar’s Palace (Las Vegas, NV)
Festival Fountain Dome
- Canaan Church (Menlo Park, CA)
Sanctuary Walls and Ceilings
- Capital Group (San Francisco, CA)
Open Office Clouds
- Carmel Clay Library (Carmel, IN)
Ceilings, Reading Rooms
- Center for Employment Training (San Jose, CA)
Auditorium
- Chicago Symphony (Chicago, IL)
Retail Store Ceiling, Floating Clouds
- Colorado State University (Ft. Collins, CO)
Ammons Hall
- Compaq Computer (TX)
Conference Rooms
- Coppers & Lybrand (Los Angeles, CA)
Reception
- Danville Library (Danville, CA)
Main Entry
- Drai’s Restaurants (Beverly Hills, CA; Las Vegas, NV)
Coffered Ceilings
- Duchesne Academy (Houston, TX)
Wall Areas Over Diffuser and Speakers

- Farallon Restaurant (San Francisco, CA)
Walls, Dining Area
- Filoli Garden Center (San Francisco, CA)
Visitor Center, Lobby Ceiling
- First Parish Church (Preston, MA)
Sloped Ceiling Sanctuary
- Flagstaff Restaurant (Boulder, CO)
Lounge Area Ceiling
- Fox TV (Los Angeles, CA)
Boardroom
- Francisca Club (San Francisco, CA)
Dining and Reception Area Ceiling
- GAP (San Bruno, CA)
Executive Conference
- GAP Clothing, Inc. (San Bruno, CA)
Corporate Hdqts., Lobby, Cafeteria, Open Offices
- Genetech (South San Francisco, CA)
Open Office Area
- Harrah's (New Orleans, LA)
Smuggler's Court Mural Wall
- Hear Center (Pasadena, CA)
Training Room
- Hearst Argyle TV (New York, NY)
Conference Room
- Hodes (Venice, CA)
Boardroom
- Janesville Country Club (Janesville, WI)
Banquet Room
- Kaiser Permanente (San Francisco, CA)
Medical Offices, Lobby Area Ceilings
- King Country Justice Center (Seattle, WA)
Public Area, Dome
- KMPG Peat Marwick (Houston, TX)
Lobby, Reception, Conference Area Ceilings
- KRIV Fox TV (Houston, TX)
Newsroom Studio
- Lucent Technologies (Denver, CO)
Control Center Ceiling
- Martin Luther King Plaza (Oakland, CA)
Auditorium Ceiling
- MC2 Restaurant (San Francisco, CA)
Skylight Feature
- McCarran Airport (Las Vegas, NV)
Children's Play Area Ceiling Clouds
- Metro National Bank (Houston, TX)
Reception Lobby Ceiling
- Microsoft Corporation (Redmond, WA)
Cafeteria Area Ceiling
- Mt. View Public Library (Mt. View, CA)
Lobby and Reading Rooms
- Nations Banc – Montgomery Securities (San Francisco, CA)
Trading Floor Ceilings
- New Mexico Visitors Center (Farmington, NM)
Floating Ceiling Clouds
- Newseum (Arlington, VA)
Ceiling Clouds / Projection Wall
- Oakmont Gardens (Santa Rosa, CA)
Dining Hall Ceiling
- Old Oak Country Club (Purchase, NY)
Club and Dining Room Ceilings
- Old Town School of Folk Music (Chicago, IL)
Concert Hall Ceilings
- Oracle (Washington, D.C.)
Corridor Ceilings
- Packard Foundation (Mountain View, CA)
Conference and Meeting Room
- Paine Webber (New York, NY)
Stock Trading Rooms, Conference Rooms
- Penzoil (Houston, TX)
Reception, Lobby Ceiling
- Pillsbury, Madison, Sutro (Palo Alto, CA)
Open Office Area, Conference Area
- Piute County Courthouse (Piute, UT)
Courtroom Ceiling
- Private Residence (Palo Alto, CA)
- Private Residence (Bedford, NY)
Dining Area
- Private Residence (Austin, TX)
Entertaining Area, Gymnasium
- Private Residence (Los Altos, CA)
Living Room Ceilings
- Private Residence (Malibu, CA)
Living Area, Exercise Room
- Private Residence (Sausalito, CA)
Living Area Ceilings
- Private Residence (Valencia, CA)
Home Theater
- Riverside Cty. Courthouse (Riverside, CA)
Courtroom Coffered Ceilings
- Robertson & Stephens (San Francisco, CA)
Elevator Lobby Ceiling
- San Jose County Government (San Jose, CA)
Auditorium
- Charles Schwab (San Francisco, CA)
Executive Conference Room
- SFX Broadcasting (New York, NY)
Lobby Ceiling Areas
- SPCA (San Francisco, CA)
Public Area Ceiling Clouds
- St. Andrew's Presbyterian Church (Tucson, AZ)
Sanctuary Wall
- St. Joseph's Hospital Chapel (Denver, CO)
Dome Ceiling
- Stanford University (Palo Alto, CA)
Schwab Residential Dining Facility Walls
- Starwood "W" Hotel (San Francisco, CA)
Dining Room, Lobby Ceiling
- Telluride Conference Center (Telluride, CO)
Meeting Rooms
- Thomas Weisel Partners (San Francisco, CA)
Trading Floor Ceiling Clouds
- U. S. Senate Building (Washington, D.C.)
Russell Library
- Underwriters Reinsurance (Ventura, CA)
Lobby and Conference Ceiling Clouds
- United House of Prayer (Chicago, Seattle, Detroit)
Sanctuary Ceilings
- University of California, Davis (Davis, CA)
Lobby
- University of Colorado (Boulder, CO)
Geological Sciences Building Auditorium
- The Academy (Boulder, CO)
Chapel Ceiling Coffers



Absol™

CONTRACT ACOUSTICAL SYSTEMS

ABSOL PORTAL
 'Sai Darshan', 231, 7th Cross, Indiranagar 1st Stage,
Bengaluru 560 038, India
 Phone +9180 2520 2803 Fax +9180 2520 3115
 Email info@absol.in www.absol.in

REGIONAL OFFICES

'Sai Prasad', 202, 4th Road, Khar (W), **Mumbai** 400 052
 Phone +9122 2649 9732 Telefax +9122 2646 5023
 Email mumbai@anutone.com

'Sai Krupa', 63 Masjid Road, Jungpura Bhogal, **New Delhi** 110 014
 Phone +9111 2437 8061 Telefax +9111 2437 4848
 Email delhi@anutone.com

'Sai Leela', 71, F024 Stonedage Tower, 1st Floor, 1st Avenue,
 Ashok Nagar, **Chennai** 600 083 Phone +9144 2474 0907 / 0908
 Email chennai@anutone.com

Anutone® and the dot waves symbol are registered trademarks of Anutone Acoustics Limited. SoundStretch™ is a trademark under registration of Absol Portal, a division of Anutone Acoustics Limited.

Owens Corning® and the red box with white curve, Eurospan are registered trademarks of Owens Corning Company, USA.

Specifications are subject to change without prior notice due to continuous improvement programmes.

Copyright Anutone® and Owens Corning®. No part of this brochure may be reproduced, stored in a retrieval system, scanned or transmitted in any form or by any means electronic, photocopying, recording or otherwise, without the prior written permission of Anutone® and Owens Corning®.

Document # 704081-500. Printed in India. April 2007.